

# Cu KONCOVKY RÚRKOVÉ

## KORI - oko rúrkové s izoláciou

**Materiál:** Cu  
**Povrchová úprava:** pocínované  
**Izolácia:** PA 6.6  
**Prevedenie:** štandard  
**Pracovná teplota:** od -30°C do +95°C

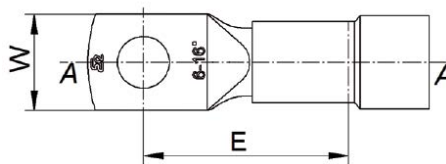
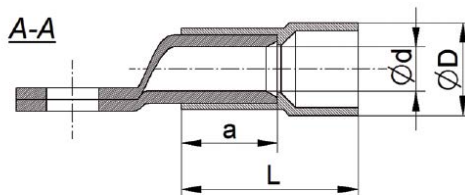

Tovar  
na objednávku

TYP	Prierez (mm <sup>2</sup> )	Otvor pre skrutku	Rozmery (mm)						Balenie (ks)	Číslo produktu
			d	D	a	E	W	L		
KORI 10/5	10	M5	4,5	7,0	10	21,0	12,0	19	100	4.0211194
KORI 10/6	10	M6	4,5	7,0	10	21,5	12,0	19	100	4.0211204
KORI 10/8	10	M8	4,5	7,0	10	23,5	15,0	19	100	4.0211214
KORI 10/10	10	M10	4,5	7,0	10	25,5	17,0	19	100	4.0211224
KORI 10/12	10	M12	4,5	7,0	10	26,5	19,0	19	100	4.0211234
KORI 16/5	16	M5	5,5	8,5	13	25,0	12,0	23	100	4.0211244
KORI 16/6	16	M6	5,5	8,5	13	25,5	12,0	23	100	4.0211254
KORI 16/8	16	M8	5,5	8,5	13	27,5	15,0	23	100	4.0211264
KORI 16/10	16	M10	5,5	8,5	13	29,5	17,0	23	100	4.0211274
KORI 16/12	16	M12	5,5	8,5	13	30,5	19,0	23	100	4.0211284
KORI 25/5	25	M5	7,0	10,0	15	28,0	14,0	26	100	4.0211294
KORI 25/6	25	M6	7,0	10,0	15	28,5	14,0	26	100	4.0211304
KORI 25/8	25	M8	7,0	10,0	15	30,5	16,0	26	100	4.0211314
KORI 25/10	25	M10	7,0	10,0	15	32,5	18,0	26	100	4.0211324
KORI 25/12	25	M12	7,0	10,0	15	33,5	19,0	26	100	4.0211334
KORI 35/6	35	M6	8,5	12,0	17	31,5	18,0	28	100	4.0211354
KORI 35/8	35	M8	8,5	12,0	17	33,5	18,0	28	100	4.0211364
KORI 35/10	35	M10	8,5	12,0	17	35,5	18,0	28	100	4.0211374
KORI 35/12	35	M12	8,5	12,0	17	36,5	20,0	28	100	4.0211374
KORI 35/16	35	M16	8,5	12,0	17	38,5	26,0	28	100	4.0211404
KORI 50/6	50	M6	10,0	14,0	19	34,5	20,0	35	100	4.0211414
KORI 50/8	50	M8	10,0	14,0	19	36,5	20,0	35	100	4.0211424
KORI 50/10	50	M10	10,0	14,0	19	28,5	20,0	35	100	4.0211434
KORI 50/12	50	M12	10,0	14,0	19	39,5	23,0	35	100	4.0211444
KORI 50/16	50	M16	10,0	14,0	19	42,5	28,0	35	100	4.0211464
KORI 50/20	50	M20	10,0	14,0	19	47,0	30,0	35	100	4.0211474
KORI 70/6	70	M6	12,0	16,5	21	40,5	23,0	37	100	4.0211484
KORI 70/8	70	M8	12,0	16,5	21	40,5	23,0	37	100	4.0211494
KORI 70/10	70	M10	12,0	16,5	21	43,5	23,0	37	100	4.0211504
KORI 70/12	70	M12	12,0	16,5	21	43,5	23,0	37	100	4.0211514
KORI 70/16	70	M16	12,0	16,5	21	46,5	28,0	37	100	4.0211534
KORI 70/20	70	M20	12,0	16,5	21	51,0	31,0	37	100	4.0211544
KORI 95/8	95	M8	13,5	18,0	24	47,0	26,0	40	50	4.0211554
KORI 95/10	95	M10	13,5	18,0	24	47,0	26,0	40	50	4.0211564
KORI 95/12	95	M12	13,5	18,0	24	47,0	26,0	40	50	4.0211574
KORI 95/16	95	M16	13,5	18,0	24	50,0	29,0	40	50	4.0211594
KORI 95/20	95	M20	13,5	18,0	24	54,5	35,0	40	50	4.0211604
KORI 120/8	120	M8	15,0	19,5	26	50,0	29,0	42	50	4.0211614
KORI 120/10	120	M10	15,0	19,5	26	50,0	29,0	42	50	4.0211624
KORI 120/12	120	M12	15,0	19,5	26	50,0	29,0	42	50	4.0211634
KORI 120/16	120	M16	15,0	19,5	26	53,0	29,0	42	50	4.0211654
KORI 120/20	120	M20	15,0	19,5	26	57,5	35,0	42	50	4.0211664

Sektorové vodiče musia byť preformátované na kruhové.